

THIS DRAWING IS UNPUBLISHED. RELEASED FOR PUBLICATION
 © COPYRIGHT - By - ALL RIGHTS RESERVED.

LOC	DIST	REVISIONS			
P	LTR	DESCRIPTION	DATE	DWN	APVD
AD	00	P3	REVISED PER ECO-11-004587	11MAR11	RK HMR

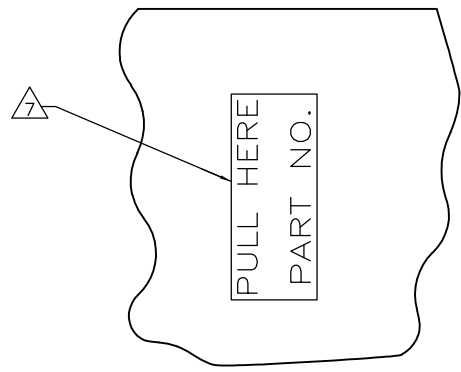
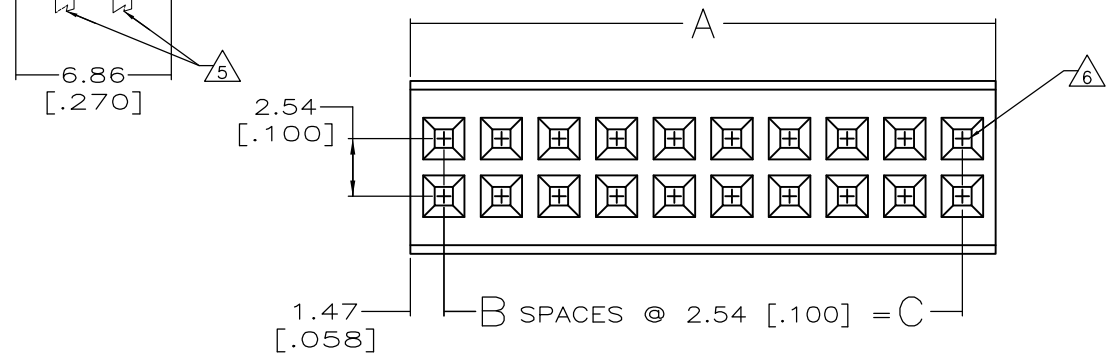
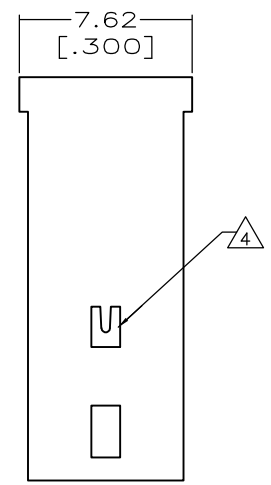
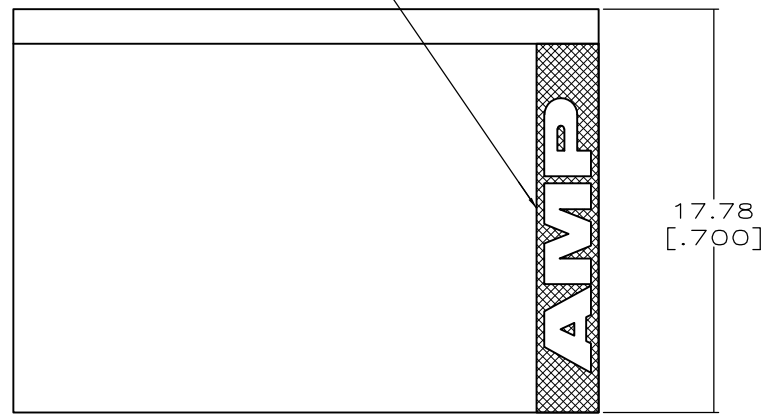
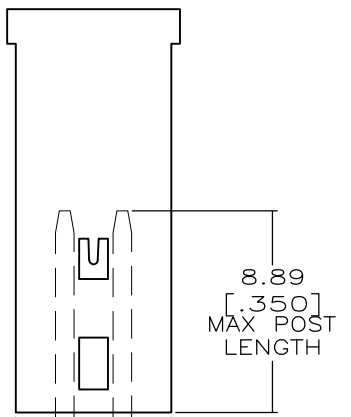
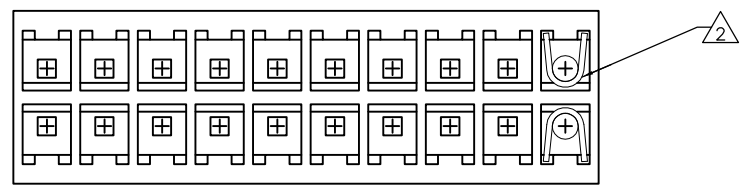

- 1 PULL ON HOUSING TO REMOVE FROM POSTS. DO NOT CONFINE THE CONDUCTORS OR PULL ON THE CONDUCTORS DURING REMOVAL ACTION.
- 2 ACCEPTS CONTACT P/N 87124.
- 4 EXTRACTION SLOT MAY BE PARTIALLY FLASHED OVER ONE END ONLY.
- 5 0.62 [.025] SQUARE POST SHOWN FOR REFERENCE ONLY.
- 6 CAVITY ACCEPTS 0.62 [.025] SQUARE POST (TYPICAL).
- 7 MARKED (WHITE) 1.5 [.06] CHARACTERS AS SHOWN IN APPROXIMATE CENTER OF HOUSING. "PULL HERE" AND "PART NO." WILL APPEAR ON HOUSINGS 6 POSITIONS AND LARGER.
- 8 AMP LOGO MOLDED IN TEXTURED AREA, AREA RAISED .0003 - .0007 HIGH AND MAY BE ON EITHER SIDE OF THE PART.
- 9 OBSOLETE PARTS: OBSOLETE CIS STREAMLINING PER D.RENAUD/D.SINISI

REMARKS	C	B	A	NO. OF POSITIONS	PART NUMBER	
9 OBSOLETE	STAMPED	20.32 [.800]	8	23.27 [.916]	18	4-87133-6
	UNSTAMPED	20.32 [.800]	8	23.27 [.916]	18	1-87133-5
	STAMPED	17.78 [.700]	7	20.73 [.816]	16	1-87133-4
	UNSTAMPED	17.78 [.700]	7	20.73 [.816]	16	1-87133-3
9 OBSOLETE	STAMPED	12.70 [.500]	5	15.65 [.616]	12	4-87133-2
	UNSTAMPED	12.70 [.500]	5	15.65 [.616]	12	1-87133-1
	STAMPED	7.62 [.300]	3	10.57 [.416]	8	1-87133-0
	UNSTAMPED	7.62 [.300]	3	10.57 [.416]	8	87133-9
	STAMPED	5.08 [.200]	2	8.03 [.316]	6	87133-8
	UNSTAMPED	5.08 [.200]	2	8.03 [.316]	6	87133-7
	STAMPED	22.86 [.900]	9	25.81 [1.016]	20	87133-6
	STAMPED	10.16 [.400]	4	13.11 [.516]	10	87133-5
OBSOLETE	STAMPED	2.54 [.100]	1	5.49 [.216]	4	87133-4
	UNSTAMPED	22.86 [.900]	9	25.81 [1.016]	20	87133-3
	UNSTAMPED	10.16 [.400]	4	13.11 [.516]	10	87133-2
	UNSTAMPED	2.54 [.100]	1	5.49 [.216]	4	87133-1

THIS DRAWING IS A CONTROLLED DOCUMENT.

DIMENSIONS: mm [INCHES]	TOLERANCES UNLESS OTHERWISE SPECIFIED: 0 PLC ± - 1 PLC ± - 2 PLC ± 0.13 [.005] 3 PLC ± - 4 PLC ± - ANGLES ± -	DWN R BROWN 27OCT2006 CHK M MILLER 27OCT2006 APVD M MILLER 27OCT2006 PRODUCT SPEC - APPLICATION SPEC - WEIGHT -	TE Connectivity HOUSING, LOCKING CLIP, .64[.025] SQUARE POST, 2.54[.100] CL CLOSED END			
MATERIAL GLASS FILLED POLYESTER COLOR: DARK BROWN OR BLACK	FINISH -	CUSTOMER DRAWING	SIZE A3	CAGE CODE 00779	DRAWING NO C-87133	RESTRICTED TO -
		SCALE 3:1	SHEET 1 OF 1	REV P3		